



**REVISED LAY OUT PLAN OF
SECTOR-" C " LOHIA NAGAR
HAPUR ROAD,MEERUT.**

AREA STATEMENT	SQ.M.
TOTAL SECTOR AREA	210517.00
AREA UNDER MASTER PLAN ROAD	20145.00
NET AREA	190372.00
AREA UNDER PLOTS	111553.00
AREA UNDER CONV. SHOPS	1200.00
AREA UNDER EDUCATIONAL	14375.00
AREA UNDER COMMUNITY CENTRE	2080.00
AREA UNDER PARK/OPEN SPACE	15792.00
AREA UNDER INTERNAL ROAD'S	45372.00

DETAIL OF PLOTS

S.NO.	TYPE	SIZE	AREA	NOS
1.	H.I.G.-1	12.00X25.00	300.00	59
2.	H.I.G.	10.00 X20.00	200.00	239
3.	M.I.G.	8.00X15.00	120.00	313
4.	L.I.G.	6.00X15.00	90.00	10
TOTAL NO.				621

NOTE

1. SITE DIMENSIONS ARE PROVIDED BY ENGINEERING DIVISION
2. HIGH TENSION ELECTRIC LINE TO BE SHIFTED

TRACED BY V.K. BHATT	SCALE:- 1:1000	DATE:- 04 - 04 - 91
-------------------------	-------------------	------------------------

A.T.P.	T.P.	COMPUTERISED BY: PAWAN
C.T.P.	SECRETARY	VICE CHAIRMAN

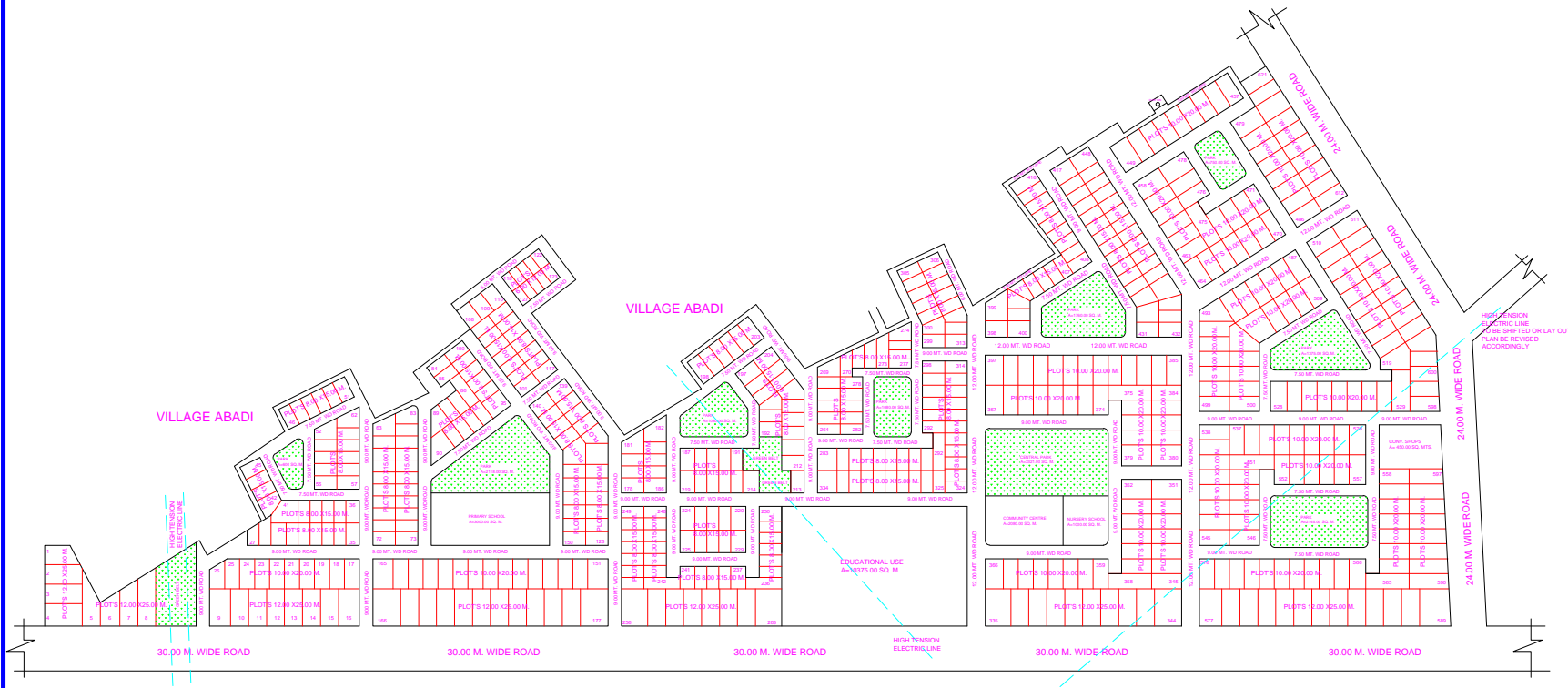

HIGH TENSION ELECTRIC LINE TO BE SHIFTED OR LAY OUT PLAN BE REVISED ACCORDINGLY